

Metric Size - R/ Rc Thread Fitting

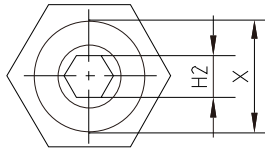

EPC/APC/ZPC
Straight

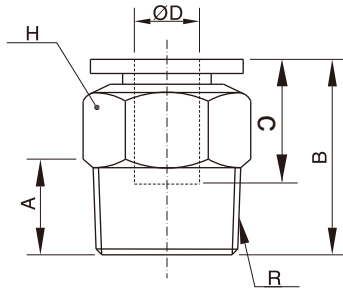

型号/MODEL	D	R	A	B	H	内六角(H2)	X	C
EPC4-M5	4	M5	4	20.8	10	2.0	10	14.9
EPC4-01	4	R1/8	8	20.3	10	3.0	10	14.9
EPC4-02	4	R1/4	11	19.4	14	3.0	10	14.9
EPC6-M5	6	M5	4	22.5	12	2.0	12	16.2
EPC6-01	6	R1/8	8	21.5	12	4.0	12	16.2
EPC6-02	6	R1/4	11	24.2	14	4.0	12	16.2
EPC6-03	6	R3/8	12	22.2	17	4.0	12	16.2
EPC6-04	6	R1/2	15	26.2	21	4.0	12	16.2
EPC8-01	8	R1/8	8.5	28	14	5.0	14	18.1
EPC8-02	8	R1/4	11	26	14	6.0	14	18.1
EPC8-03	8	R3/8	12	23.6	17	6.0	14	18.1
EPC8-04	8	R1/2	15	27	21	6.0	14	18.1
EPC10-01	10	R1/8	8.5	30.8	17	5.0	17	20.5
EPC10-02	10	R1/4	11.5	33	17	6.0	17	20.5
EPC10-03	10	R3/8	12	28.6	17	8.0	17	20.5
EPC10-04	10	R1/2	15	27	21	8.0	17	20.5
EPC12-01	12	R1/8	8.5	32.6	21	5.0	20	22.7
EPC12-02	12	R1/4	11.5	35.6	21	6.0	20	22.7
EPC12-03	12	R3/8	12.5	31.1	21	8.0	20	22.7
EPC12-04	12	R1/2	15	34.1	21	8.0	20	22.7
EPC14-02	14	R1/4	11.5	38.2	22	6.0	23.5	24.6
EPC14-03	14	R3/8	12.5	39.2	22	8.0	23.5	24.6
EPC14-04	14	R1/2	15	35.7	22	10.0	23.5	24.6
EPC16-03	16	R3/8	12.5	40.1	24	8.0	23.5	25
EPC16-04	16	R1/2	15.5	37.1	24	10.0	23.5	25